

SALEM

447 S. BROADWAY, SALEM, NH 03079



PROPERTY HIGHLIGHTS

METRO AREA: Other Markets

COUNTY: Rockingham

Salem is a free-standing retail building net leased to entertainment user Fun City. The property sits along a heavily trafficked retail corridor area that includes retailers such as Market Basket, Dick's Sporting Goods, Kohl's, Barnes & Noble, Target, Walmart and other national retailers. The center is approximately a half-mile north of the New Hampshire / Massachusetts border and 3-miles south of Simon's 1.2M SF Rockingham Park super regional mall.

TOTAL SF
38,898

ACRES
2.6

PARKING SPACES
193

PARKING RATIO
4.96:1,000 SF

CENTER TYPE
Street Retail Bldg

DEMOGRAPHICS 3-MILE RADIUS

 **81,810**
POPULATION

 **40.2**
MEDIAN AGE

 **\$108,710**
AVERAGE HHI

 **27.3%**
COLLEGE
EDUCATED

LEASING AGENTS

JOSHUA BIRNS | jbirns@uedge.com | 212-956-2235

#	TENANTS	SQFT
1	Fun City	38,898

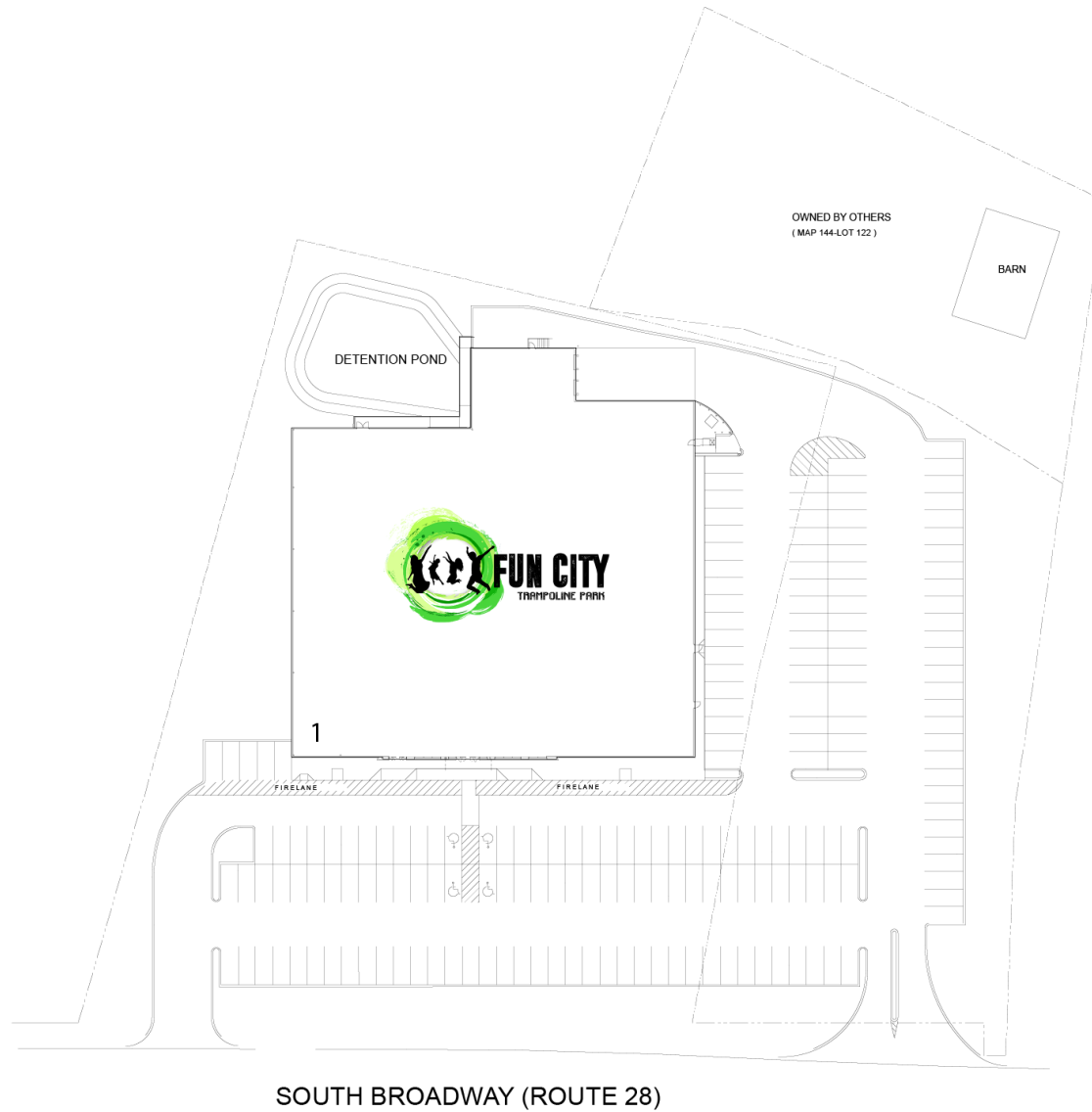

THIS EXHIBIT SHALL NOT BE DEEMED A WARRANTY, REPRESENTATION OR AGREEMENT BY LANDLORD THAT THE LAYOUT OR CONFIGURATION OF THE SHOPPING CENTER, OR ANY PART THEREOF, SHALL REMAIN AS SHOWN HEREON.

LANDLORD RESERVES THE RIGHT TO MODIFY THE SHOPPING CENTER, OR ANY PART THEREOF, IN ACCORDANCE WITH THE PROVISIONS OF THE LEASE.